

STUDENT PARKING LOT

| | | | | | |
|------------|-----|-----|-----|-----|-----|
| 211 | 209 | 207 | 205 | 203 | 201 |
| 212 | 210 | 208 | 206 | 204 | 202 |
| B BUILDING | | | | | |
| 109 | 107 | 105 | 103 | | |
| 110 | 108 | 106 | 104 | | |

| | | | | | |
|------------|-----|-----|-----|-----|-----|
| 209 | 207 | 205 | 203 | 201 | |
| 210 | 208 | 206 | 204 | 202 | |
| A BUILDING | | | | | |
| 111 | 109 | 107 | 105 | 103 | 101 |
| 112 | 110 | 108 | 106 | 104 | 102 |

BROADMOOR HIGH

Telephone: 926-1420
 Fax: 928-5472

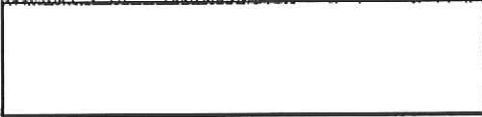
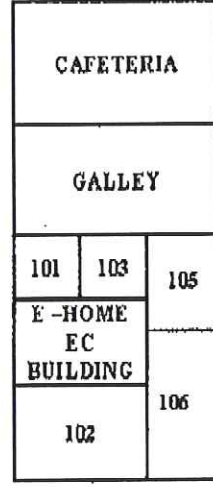
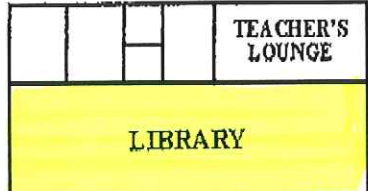
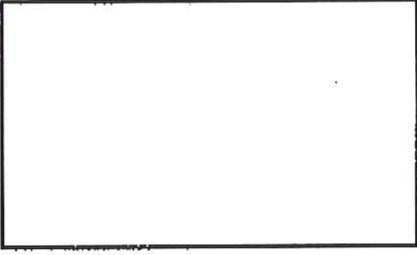
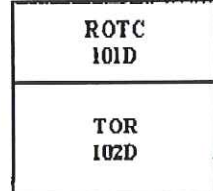
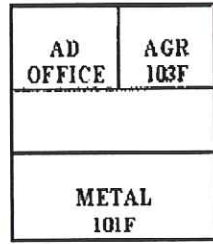
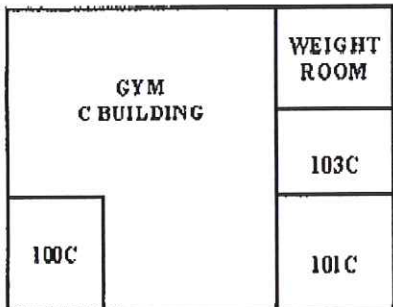

T1 T2

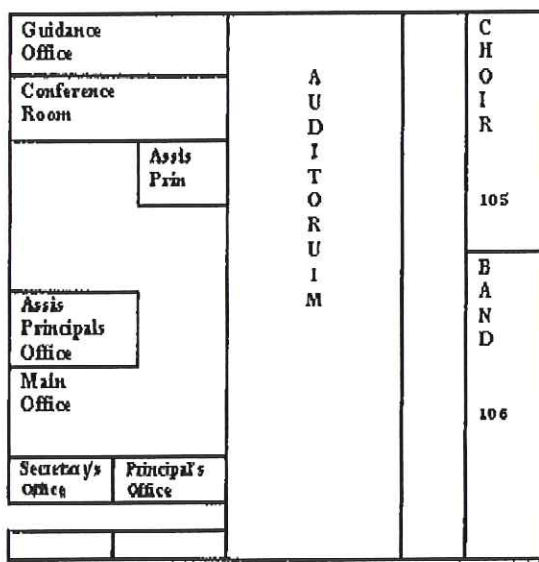

BAND PARKING LOT

GOODWOOD BLVD